

# ELECTRIC-SOLAR-PASSENGER SHIP/FERRY

- > Emission free, Noiseless, Economical
- > Powerful solar system
- > Fully optimized energy system
- > Maximum efficiency by optimized electronic control
  
- > Hull shape: streamlined, minimal resistance, minimum mass
- > Ship hull: maximum robustness, minimum maintenance costs
- > Individually engineered for each area of operation
- > High safety, redundant systems
- > All BinSchUO (Germany) approval zones possible.



Made in Germany!



## Ampereship GmbH

Ampereship is an innovation driven, technologically advanced company with huge experiences in building Solar/Electric Passenger ships and Ferries.

Our Solar powered ships can be driven totally by electrical power due to efficient, hydrodynamic design. Our ships are designed in a way that uses less energy than other (semi) solar-powered ships and therefore a diesel engine is obsolete. This makes Ampereship: your economic and environmentally friendly partner in shipbuilding.





Ampereship

## Comparison of costs

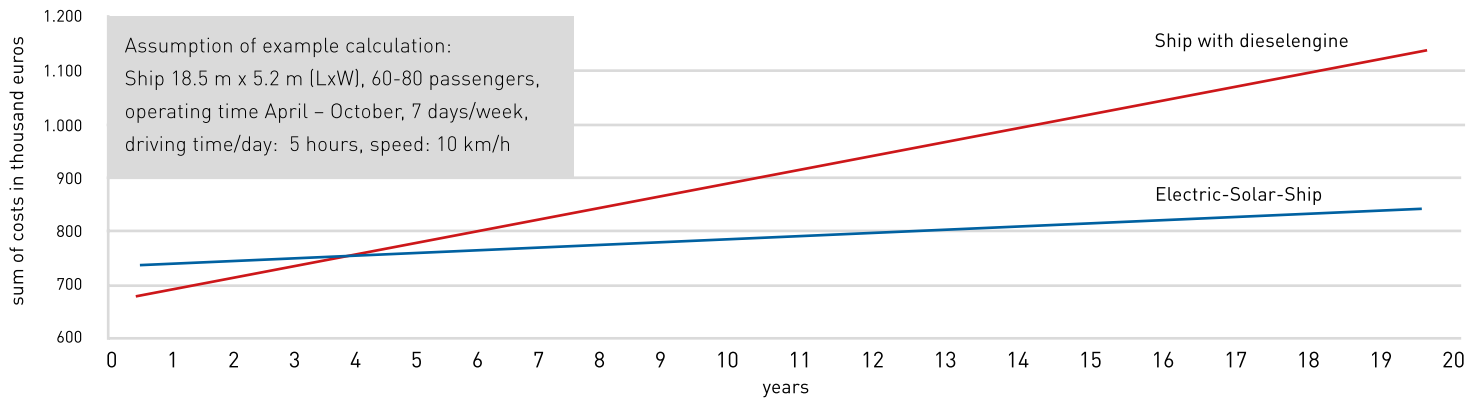

### Option 1

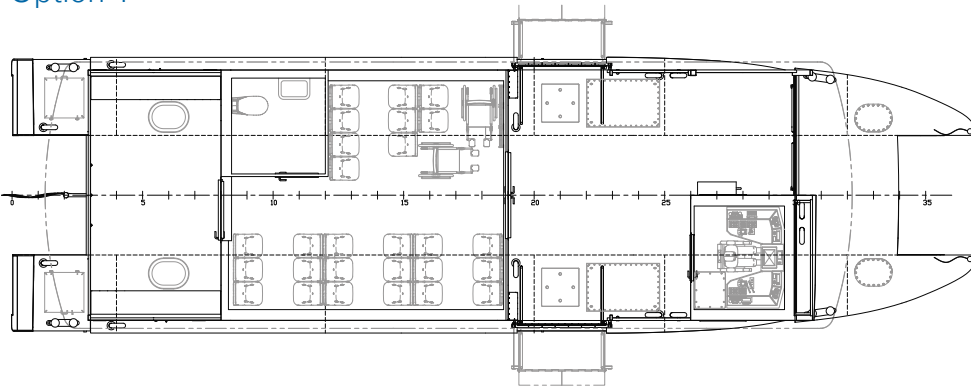

### wheelchair ramp



### Option 2

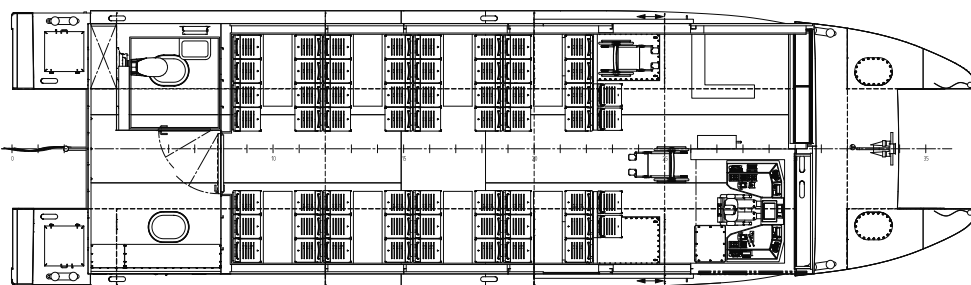

### bowthruster



### Main features

Length overall:	18,50 m
Width overall:	5,22 m
Draught:	ca. 0,60 m
Hight above waterline:	3,46 m w/o Mast
Service speed:	7 km/h
Maximum speed:	13 km/h

Motorization and dimensions variable according to customer requirements up to 2 x 75kW possible. Drive propeller electrically rotatable 360°. All BinSchUO (Germany) approval zones possible.

### Option 1

35 seats & 15 standing places
2 x wheelchairs
15 bicycles
Optional Handicap-Accessible toilet

### Option 2

60 seats
2 x wheelchairs
Optional Handicap-Accessible toilet

### Propulsion

Rudder propellers:	2 x 15 kW
Bow thruster:	1 x 6 kW
Batteries:	Lithium-Polymer
Solar modules:	52
Total area:	ca. 66 m <sup>2</sup>
Overall capacity:	14,6 kWp